

## TAKER B70 SHIELD LIGHT WITH TRI-GRIP HANDLE WITH CUFFS

---

480-680

### INSTALLATION GUIDE

# TAKER B70 REFERENCE GUIDE

---

## LIGHT HEAD (FRONT)

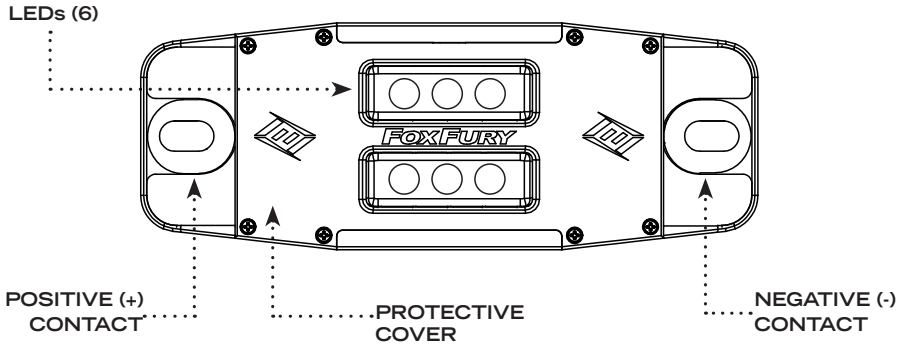

## HANDLE (FRONT SIDE)

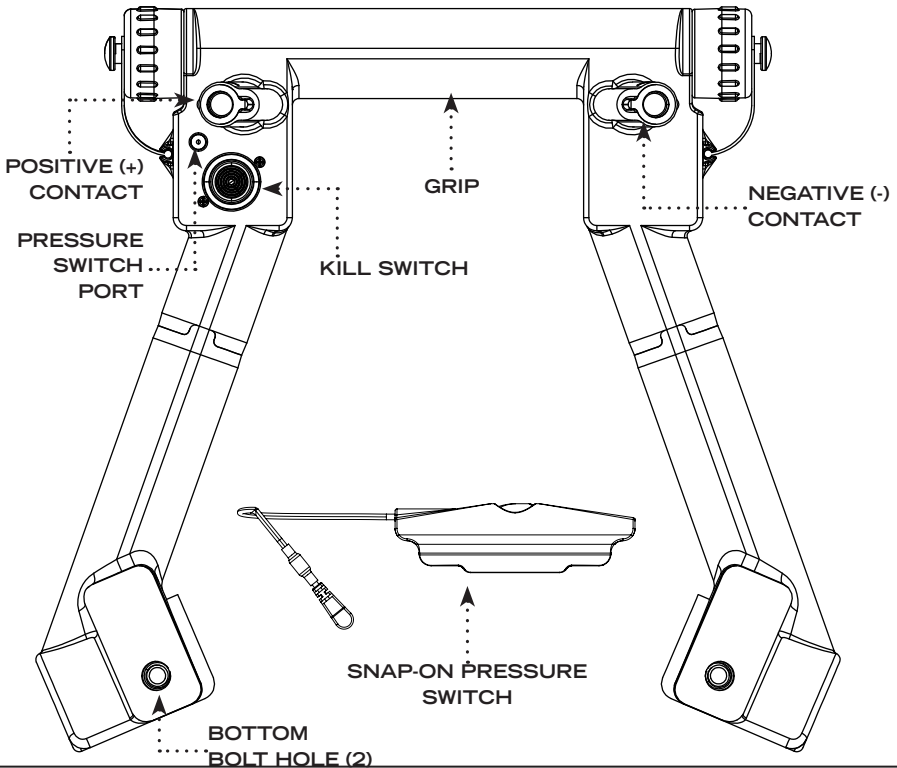

## HANDLE (BACK SIDE)

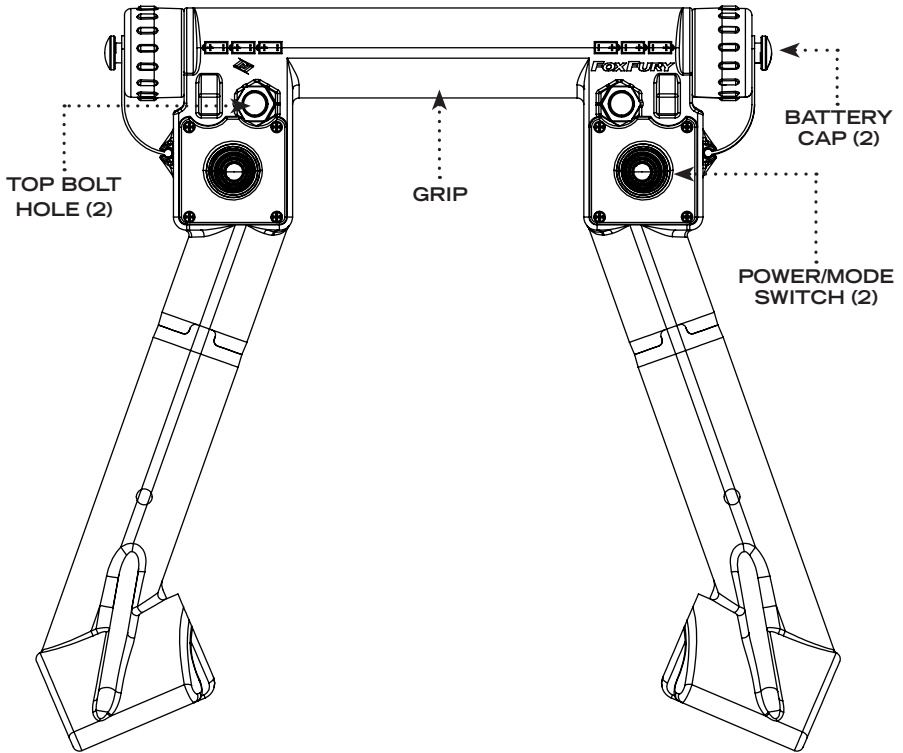

## WHAT'S INCLUDED

---

- ❖ Taker B70 Light Head, Bolt Connection, P/N 600-480-670
- ❖ Taker B70 Tri-Grip Handle with Cuffs & Electronics, P/N 60-608
- ❖ Snap-On Pressure Switch, P/N 35-018
- ❖ (2) Grade 8 Washer
- ❖ (4) Star Lock
- ❖ (2) Sleeve - To be used with 5/16"-18 Bolt Only
- ❖ (2) Foam - To be used with Flat Shield Only
- ❖ (4) 3M Dual Lock Strip 2" x 1" - Optional for installation of bottom section of Handle

# ITEMS REQUIRED

- ❖ (2) Grade 8 Bolt: 5/16"-18 or 3/8"-16  
Bolt Length: 97 mm plus shield thickness
- ❖ (2) Grade 8 Bolt: 3/8"-16  
Bolt Length: 97 mm plus shield thickness
- ❖ (4) Nut: 5/16"-18 or 3/8"-16
- ❖ (2) Bellville or (2) Split Washer
- ❖ Wrench or Socket: 1/2" or 9/16"

# INSTALLATION

The Taker B70 is intended to be installed as an OEM product, by ballistic shield and armor manufacturers.

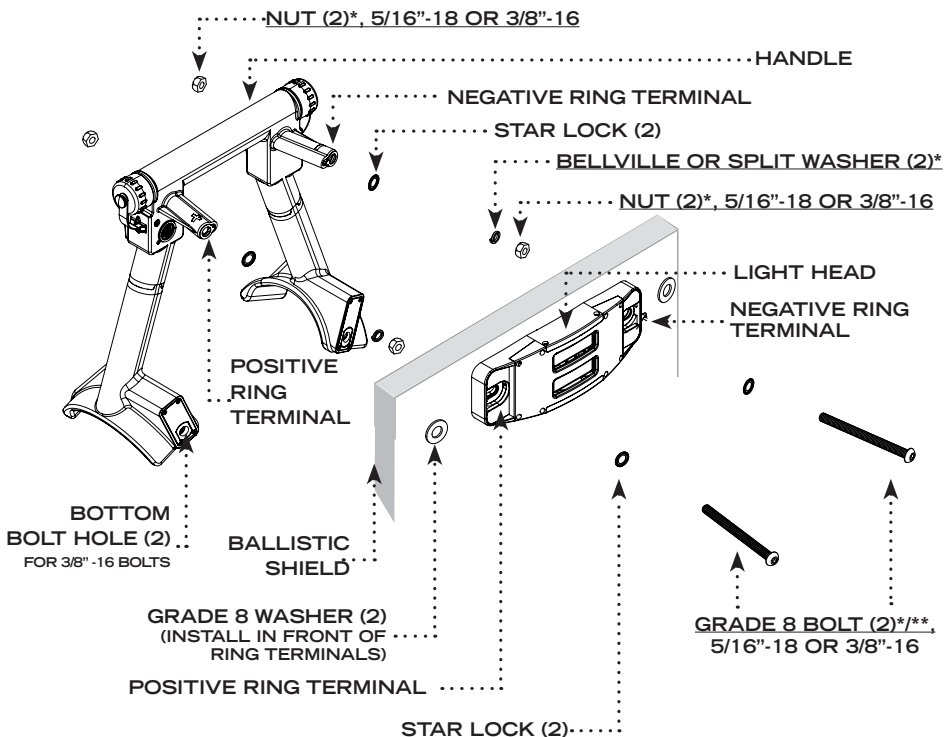

# INSTALLATION (CONT'D)

---

- 1 Begin by drilling holes into the shield. To do this, find the 2 Top Bolt Holes & 2 Bottom Bolt Holes locate on the BACK SIDE of the Handle (see p. 2, 3 & 5). Install as the illustration.

 **HELPFUL TIP:** Use a #2 pencil (or a tool of the same diameter) and insert it through the Bolt Holes (of the BACK SIDE of the Handle) to draw two marks on the shield. This will help when determining placement of the holes when drilling.

 The center-center bolt distance measured from the Handle at the top bolt holes is 165 mm and at the bottom bolt holes is 205 mm. Drill holes at a diameter to match your bolt size, and the tolerances that you designate.

- 2 Test the light's performance by deactivating Kill Switch and pressing Power/Mode Switch on either Handle.

## IMPORTANT:

\*The underlined items on p. 4 are NOT included and must be supplied by the shield manufacturer.

\*\* When using 5/16"-18 Bolt, install the supplied Sleeve in each Handle. When using 3/8"-16 Bolt, the Sleeves are not needed for installation.

\*\*\* The center-center bolt distance measured from the Handle at the ring terminal is 165 mm. Drill holes at a diameter to match your bolt size, and the tolerances that you designate.

