



## INSTRUCTION MANUAL SPEED RING ADAPTOR

P/N 85-047

INCLUDED:

- ❖ Nylon Bolt Caps (4)
- ❖ Thumbscrews (4)
- ❖ Speed Ring Adaptor (1)

SPECIFICATIONS:

- ❖ Aluminum Construction, Black Anodized
- ❖ Fits most 6" diameter speed rings
- ❖ For use with Nomad Prime and P56

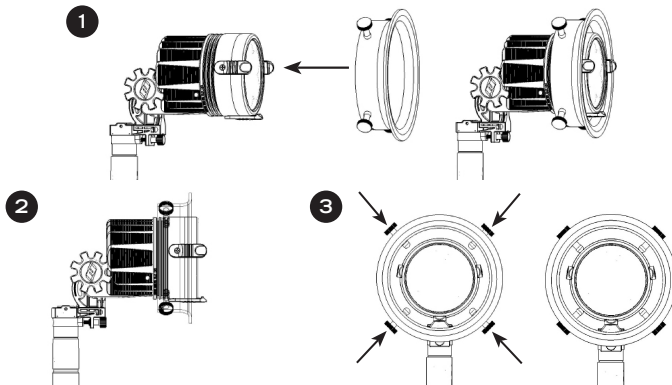

## INSTALLING THE FOXFURY SPEED RING ADAPTOR

1. Make sure the Tilt Adjustment Knob on the Nomad® Prime and P56 light head is tightened. Then, fit the Speed Ring Adaptor over the Nomad® Prime and P56.
2. Adjust the Speed Ring Adaptor to the light head based on user preference. NOTE: FoxFury suggests aligning the center-point of the four (4) Thumbscrews with any one (1) of the three (3) grooves that are cut into the light head—this will help to secure your softbox.
3. Tighten the four (4) Thumbscrews to secure the Speed Ring Adaptor to the Nomad Prime and P56.

## INSTALLING A SOFTBOX TO THE SPEED RING







- ❖ Follow the instructional steps listed in your softbox manual for assembly of the softbox to the FoxFury Speed Ring Adaptor.
- ❖ Make sure to REMOVE the standard adaptor included with your softbox.
- ❖ FoxFury recommends pre-installing the softbox to the Speed Ring prior to tightening it on the Nomad Prime and P56 light head.
- ❖ CAUTION: Use caution when adjusting or removing the Speed Ring or softbox from the light head after extended use, as it may be HOT.

# WARRANTY AND OTHER INFORMATION

---

## WARNINGS

FoxFury, LLC is not responsible for the incorrect use of any FoxFury Lighting product.

-  When used for extended periods of time the Nomad® will become HOT to the touch. Please use care when operating.
-  Do not stare into LEDs for long periods of time or from a close range (less than 2 ft).
-  FoxFury, LLC is not responsible for any injury or damage caused during the use of this product.
-  Usage of this product must be supervised by an adult when it is being used by a minor.
-  Any FoxFury product should be operated at speeds safe enough to maneuver around surrounding obstacles.
-  Do not use under the influence of drugs or alcohol.

SUCH LIMITATION IS PROHIBITED BY LAW.

You may have other specific legal rights which vary by jurisdiction. Go to [www.foxfury.com/pages/warranty](http://www.foxfury.com/pages/warranty) for a complete copy of the warranty. Retain your receipt for proof of purchase.

## CONTACT FOXFURY

FoxFury, LLC  
Oceanside, CA 92056 USA  
**Toll-Free:** 844-FOXFURY  
**Tel:** 760.945.4231  
**Fax:** 760.433.3650  
**Email:** [service@FoxFury.com](mailto:service@FoxFury.com)  
**Web:** [FoxFury.com](http://FoxFury.com)

All FoxFury products are designed in Oceanside, CA. All FoxFury products are manufactured with the highest quality USA and foreign parts. Products are assembled in either FoxFury's controlled plant in Asia or the USA, under strict quality control.

## LIMITED LIFETIME WARRANTY

FoxFury, LLC ("FoxFury") warrants this product to be free from defects in material for a lifetime of use except for batteries, LEDs, abuse, and normal wear. We will repair or replace this product should we determine it to be defective. This limited lifetime warranty excludes rechargeable batteries, chargers, switches, and electronics, which have a 2-year warranty with proof of purchase.

This limited lifetime warranty is given only to the original end user of the accompanying product. If you purchased a product from someone other than an authorized FoxFury reseller/distributor or if the product was used, (including but not limited to demo models, show models or refurbished product by someone other than FoxFury) prior to your purchase, you are not the Original Purchaser and the product that you purchased is not covered by this warranty. This limited warranty is VOID if this Product has been altered or modified in any way (including but not limited to attempted warranty repair without authorization from Foxfury and/ or alteration/removal of the serial number). To expedite warranty concerns, we encourage the end user to register their FoxFury Product at [www.foxfury.com/pages/warranty-registration](http://www.foxfury.com/pages/warranty-registration).

THIS IS THE ONLY WARRANTY, EXPRESSED OR IMPLIED, INCLUDING ANY WARRANTY OF MERCHANTABILITY OR FITNESS FOR A PARTICULAR PURPOSE. INCIDENTAL, CONSEQUENTIAL OR SPECIAL DAMAGES ARE EXPRESSLY DISCLAIMED EXCEPT WHERE